

Permit Number ROW2023-03186
Application Date 06/22/2023
Date Permit Issued 07/12/2023
Date Permit Expires 01/08/2024

ROW Permit

TYPE:
TYPE A SPECIAL USE



Site Address

SE 24TH ST

Parcel Number

1124069006

Contractor Information

CONTRACTOR UNKNOWN

Contractor License Number

Contractor License Expiration

Owner Name / Address

Project Description

ROW TYPE-A - BEAVER LAKE TRIATHALON

1/4 mile swim in Beaver Lake 13.7 mile Bike around the surrounding Neighborhood and King County 4.3 mile Run around beaver Lake and surrounding neighborhood and park

Permit Number ROW2023-03186
Application Date 06/22/2023
Date Permit Issued 07/12/2023
Date Permit Expires 01/08/2024

ROW Permit

TYPE:
TYPE A SPECIAL USE



Site Address

SE 24TH ST

Parcel Number

1124069006

Contractor Information

CONTRACTOR UNKNOWN

Contractor License Number

Contractor License Expiration

Owner Name / Address

Project Description

ROW TYPE-A - BEAVER LAKE TRIATHALON

1/4 mile swim in Beaver Lake 13.7 mile Bike around the surrounding Neighborhood and King County 4.3 mile Run around beaver Lake and surrounding neighborhood and park

Permit Validity: The issuance or granting of a permit shall not be construed to be a permit for, or an approval of, any violation of any of the provisions of the Sammamish Municipal Code or any other State or Federal Laws.

I have read and understand all terms and conditions contained on both pages of this document. The undersigned hereby accepts this Permit subject to the terms and conditions as herein set forth.

Owner / Agent Signature _____ Date _____

Permit Number ROW2023-03186

Condition Number Condition

1 The following special conditions are placed on the approval of this permit:

1. Applicant shall initiate a Job Start through www.MyBuildingPermit.com a minimum of one (1) week prior to the event. Applicant will be assigned a Sammamish Public Works construction inspector to coordinate the event.
2. At least ONE (1) WEEK prior to the event, erect, maintain and remove, immediately following the event, all signage along the proposed route(s) notifying motorists of the pending event. Coordinate signage location with construction inspector.
3. Event and route signs shall be the corrugated plastic signs similar to election signs. Only wire frame sign supports shall be used. No wood stakes shall be used signs. Sign placement shall be in such a fashion as to not obstruct the safe passage of pedestrians or motor vehicles nor shall they obstruct the vision of pedestrians and motorists.
4. All runners/bicyclists/event participants shall obey all "rules of the road" during this event. All traffic signs, traffic signals and pedestrian cross walks shall be observed in accordance with current motor vehicle laws.
5. Emergency vehicles shall have priority and bicyclists shall treat emergency vehicles in the same manner as a driver of a motor vehicle by pulling to the right and stopping.
6. Local vehicles shall receive priority access at all times during the event.
7. Applicant shall clean-up all event related debris from along all proposed route(s).
8. Any temporary event related sidewalk and/or pavement markings shall be done using non-permanent materials.
9. Roadway(s), sidewalk(s) or trail closures are not allowed within the City of Sammamish limits for this event.
10. Event volunteers shall wear reflective safety vests.
11. Event volunteers shall not direct motor vehicle traffic unless noted on the approved documents. Volunteers flagging for this event must have a current flagger certification card issued by the state of Washington. Copies of the certifications must be provided to the construction inspector.
12. Event coordinator is Michael Brisbois who can be reached for non-emergency matters at (708) 668-5488 or via email mic@beaverLakeTriathlon.com
13. Event's personnel shall man an Event Command Stations for event participant support.
14. Event Coordinator shall provide Sammamish Police and Eastside Fire and Rescue with the Event's Command Center contact number the day before the event.
15. All Event personnel shall be familiar with their location(s) and be able to provide specific location

information such as an address, intersection or other specific landmark information in the event a 911 call is made so Sammamish Police and Eastside Fire and Rescue can provide prompt service.

16. Event Coordinator shall coordinate with Melissa Lucas, Sammamish Senior Traffic Signal Technician, in the event a traffic signal manned by an off duty uniformed police officer is switched to flashing red. Ms. Lucas' contact information is 425-295-0532 and mlucas@sammamish.us.

17. If shoulder cleaning is needed prior to the event, you may request this be performed by adding your request through SeeClickFix by visiting <https://www.sammamish.us/how-do-i/my-sammamish-fix-it/>. For assistance or questions with this, please contact Colleen Rupke, at 425-952-2115.

If there are any questions with respect to this permit, please feel free to contact Stephen Noeske, Development Review Manager at 425-295-0588 or email at snoeske@sammamish.us.

Permit Number: ROW2023-03186

Permit Conditions

City of Sammamish

Permit Number: ROW2023-03186

Description: ROW TYPE-A - BEAVER LAKE TRIATHALON

Applied: 6/22/2023

Approved: 7/12/2023

Site Address: SE 24TH ST

Issued: 7/12/2023

Finalized:

City, State Zip Code: SAMMAMISH, WA 98075

Status: ISSUED

Applicant: MICHAEL BRISBOIS

Parent Permit:

Owner: <NONE>

Parent Project:

Contractor: CONTRACTOR UNKNOWN

Details:

1/4 mile swim in Beaver Lake 13.7 mile Bike around the surrounding Neighborhood and King County 4.3 mile Run around beaver Lake and surrounding neighborhood and park

LIST OF CONDITIONS

SEQ NO	ADDED DATE	REQUIRED DATE	SATISFY DATE	TYPE	STATUS
DEPARTMENT		CONTACT		REMARKS	

Permit Conditions

City of Sammamish

1	7/12/2023			PW- ROW	Satisfied
Public Works		STEPHEN NOESKE			

Notes:

The following special conditions are placed on the approval of this permit:

1. Applicant shall initiate a Job Start through www.MyBuildingPermit.com a minimum of one (1) week prior to the event. Applicant will be assigned a Sammamish Public Works construction inspector to coordinate the event.
 2. At least ONE (1) WEEK prior to the event, erect, maintain and remove, immediately following the event, all signage along the proposed route(s) notifying motorists of the pending event. Coordinate signage location with construction inspector.
 3. Event and route signs shall be the corrugated plastic signs similar to election signs. Only wire frame sign supports shall be used. No wood stakes shall be used signs. Sign placement shall be in such a fashion as to not obstruct the safe passage of pedestrians or motor vehicles nor shall they obstruct the vision of pedestrians and motorists.
 4. All runners/bicyclists/event participants shall obey all "rules of the road" during this event. All traffic signs, traffic signals and pedestrian cross walks shall be observed in accordance with current motor vehicle laws.
 5. Emergency vehicles shall have priority and bicyclists shall treat emergency vehicles in the same manner as a driver of a motor vehicle by pulling to the right and stopping.
 6. Local vehicles shall receive priority access at all times during the event.
 7. Applicant shall clean-up all event related debris from along all proposed route(s).
 8. Any temporary event related sidewalk and/or pavement markings shall be done using non-permanent materials.
 9. Roadway(s), sidewalk(s) or trail closures are not allowed within the City of Sammamish limits for this event.
 10. Event volunteers shall wear reflective safety vests.
 11. Event volunteers shall not direct motor vehicle traffic unless noted on the approved documents. Volunteers flagging for this event must have a current flagger certification card issued by the state of Washington. Copies of the certifications must be provided to the construction inspector.
 12. Event coordinator is Michael Brisbois who can be reached for non-emergency matters at (708) 668-5488 or via email mic@beaverLakeTriathlon.com
 13. Event's personnel shall man an Event Command Stations for event participant support.
 14. Event Coordinator shall provide Sammamish Police and Eastside Fire and Rescue with the Event's Command Center contact number the day before the event.
 15. All Event personnel shall be familiar with their location(s) and be able to provide specific location information such as an address, intersection or other specific landmark information in the event a 911 call is made so Sammamish Police and Eastside Fire and Rescue can provide prompt service.
 16. Event Coordinator shall coordinate with Melissa Lucas, Sammamish Senior Traffic Signal Technician, in the event a traffic signal manned by an off duty uniformed police officer is switched to flashing red. Ms. Lucas' contact information is 425-295-0532 and mlucas@sammamish.us.
 17. If shoulder cleaning is needed prior to the event, you may request this be performed by adding your request through SeeClickFix by visiting <https://www.sammamish.us/how-do-i/my-sammamish-fix-it/>. For assistance or questions with this, please contact Colleen Rupke, at 425-952-2115.
- If there are any questions with respect to this permit, please feel free to contact Stephen Noeske, Development Review Manager at 425-295-0588 or email at snoeske@sammamish.us.



RIGHT-OF-WAY PERMIT

801 228th Avenue SE
Sammamish, WA 98075
www.sammamish.us

Phone: 425-295-0500
Fax: 425-295-0600

JOB START / INSPECTION REQUEST LINE: (425) 295-0515 – 48 HOURS NOTICE REQUIRED

Subject to all terms, conditions, and provisions written or printed below or on any part of this form

PERMISSION IS HEREBY GRANTED TO:

Contractor/Applicant _____ Phone _____ Date _____

Address _____ City _____ State _____ Zip _____

Email: _____

Description of work in the public right-of-way: _____

For (Name and Phone): _____

Project Address: _____ Email: _____

- | | | |
|---|-----------------------|----------------------|
| 1. Utility to be placed/Installed per City approval | DOES NOT APPLY | Project Valuation \$ |
| 2. Any underground work shall require notification to other underground installations, Gas, Power, Telephone, Cable TV, Water, Sewer or Storm Drain. To locate underground utilities, call 811. | | |

3. This permit shall expire if no work has commenced within 180 days of permit issuance.

- | | |
|--|-----------------------|
| 4. All trenches to have a backfill of not less than 36 inches (depth – to top of the pipe) and the finished surface will conform with the original surface, unless otherwise approved in writing by the City Engineer. | |
| 5. All trenches located beneath paved (asphalt or concrete) surfaces or driveways or located beneath roadway shoulders (within 3 feet of edge of road) shall be back-filled with crushed surfacing top course (5/8-inch minus) or controlled density fill (CDF). Backfill shall be placed and compacted in maximum 6-inch lifts to 95% of standard density. Native excavated materials cannot be utilized for backfill in these areas. | |
| 6. All trenches located outside of paved (asphalt or concrete) surfaces or driveways, or outside roadway shoulders shall be back-filled in 6-inch lifts with suitable excavated material compacted to 95% of standard density. When unsuitable on-site native backfill, material exists (material cannot achieve minimum compaction requirements), then trenches shall be back-filled with import gravel base, Class B, material as furnished and supplied by the Grantee. Grantee warrants the availability or presence of suitable native materials for trench backfill. | DOES NOT APPLY |
| 7. All compaction shall be mechanically tamped to achieve the desired level of compaction. Water settling will not be allowed. | |
| 8. All asphalt pavement restoration shall be made with a minimum 6-inch lift of compacted (95% standard density) CSTC (5/8-inch minus) and 3-inch minimum (compacted thickness) of HMA 1/2-inch. The pavement restoration shall extend a minimum of 12-inches (each side) beyond the constructed trench widths. When existing asphalt thickness is found to be greater than 2 inches, HMA 1/2-inch shall be placed, in maximum 2-inch lifts, to a depth of 1-inch over existing pavement thickness. Seal edges with sealer CSS1 and seal surface joint with hot asphalt. | |
| 9. Special trench and pavement restoration will be required for trenching through concrete or "asphalt over concrete" pavement roadways. The Grantee shall procure those additional requirements from the City prior to commencing work under this permit. | |
| 10. Before repair of asphalt concrete cuts, the City shall be notified (24-hour prior) of pending work and all such work shall be made by experienced personnel with adequate equipment. All paving material shall be HMA 1/2-inch (PG64-22). | |
| 11. No pavement cuts across streets, roads, or driveways constructed of HMA or Portland Cement Concrete shall be made, unless approval has been granted by the Public Works Director, or the City Engineer, or his authorized representative, in writing for such crossing. Only mechanical saws specifically made for this purpose shall make all pavement cuts, or as otherwise approved. | |

12. Property owners and/or residents along this project shall have the right of safe ingress and egress at all times.

13. At no time during construction will any roadway be entirely closed, unless otherwise approved. One-way traffic shall be maintained at all times. Traffic control and construction signs shall be provided, installed, and maintained in accordance with the latest issue of

the Manual on Uniform Traffic Control Devices (MUTCD). All flaggers shall be State certified. Approved traffic control plans must be on site at all times.

14. A crushed rock (minimum 2-inch compacted thickness) surface shall be placed for gravel shoulder restoration, as shown on approved plans. Where grass sod currently exists, a 4-inch lift of compacted topsoil and grass sod shall be reinstalled. Where construction occurs on a graveled surface, a 2-inch compacted lift of crushed rock surfacing (5/8-inch minus) shall be provided to all disturbed graveled surfaces.

DOES NOT APPLY

15. Once work commences, it shall be diligent satisfaction of the City Public Works Department.

16. A temporary patch of cold mix asphalt (4-inch minimum compacted thickness) will be placed and maintained on all road crossings and driveways after back filling. A permanent patch shall be placed within 30 days after completion. Permanent patching will be done by the permittee.

17. A COPY OF THIS PERMIT MUST BE PRESENT AT THE WORK SITE AT ALL TIMES. WORK MUST CONFORM 100% TO PERMIT.

18. No work shall be done under this permit until the party or parties to whom it is granted shall be communicated with and received instructions, if required, from the local school district, police, private utility companies, and local Fire Marshall. The Fire Marshall and Police Department must be notified prior to and after completion of the work or project.

19. **Payment of all permit fees shall be calculated by the City of Sammamish and paid by the Permittee before issuance of this permit, unless the applicant is a utility and covered under the current utility billing arrangement.**

20. A record "as built" of city-owned facilities must be provided to the City in an approved format upon completion of the project.

21. The contractor shall submit a Certificate of Insurance to the City of Sammamish as additional insured. The insurance shall meet the requirements as listed in Exhibit A (attached).

DOES NOT APPLY

GENERAL PROVISIONS APPLICABLE TO ALL RIGHT-OF-WAY PERMITS

- A. During the progress of the work, such barriers and warning signs (in accordance with the Manual on Uniform Traffic Control Devices) shall be erected and maintained by the Grantee as may be necessary or as may otherwise be directed by the City for the protection of the traveling public; the barriers shall be properly lighted when necessary and promptly removed when the project is completed. 24-inch cones with 6-inch reflector bands shall be used.
- B. In accepting this Permit, the Petitioner, his successors or assigns, agrees to protect the City and safe it harmless from all claims, actions or damages of every kind and description which may accrue to or be suffered by any person or persons, corporation or property by reason of the performance of any such work, character of materials used or manner of installation, maintenance and operation or by the improper occupancy of rights of way and public place or public structure, and in this case any suit or action is brought against said City for damages arising out of or by reason of any of the above causes, the petitioner, his successor or assigns will upon notice to him or them of commencement of such action, defend the same at his or their own sole cost and expense and will satisfy judgment after the said suit or action shall have finally been determined if adverse to the City.
- C. Except as herein authorized, no excavation shall be made or obstacle placed within the limits of a city street or easement in such a manner as to interfere with the travel over said road, or create a safety hazard.
- D. If the work done under the Permit interferes in any way with the drainage of the city streets, or causes damage, the Grantee shall wholly and at his own expense, make such provisions as the City Engineer may direct to take care of said drainage and/or damage. Installation of any utilities in any City storm conveyance system is strictly prohibited (except right angle crossings). When ditch sections or open conveyance systems are disturbed, the ditch section or conveyance system shall be restored and armour plated with quarry spalls to the City's satisfaction. The Grantee is responsible for protecting the storm system from erosion. Existing systems shall be protected and cleaned as required. The Grantee shall utilize Best Management Practices outlined by the Department of Ecology.
- E. On completion of said work, all rubbish and debris shall be immediately removed and the roadway and roadside shall be left neat and presentable and satisfactory to the City Engineer or designee.

F. Grantee shall comply with the Washington Specifications, current edition. Where ;	DOES NOT APPLY	Washington State Department of Transportation Standard. It be the sole judge as to the prevailing requirement(s).
--	-----------------------	---

- G. No work shall be permitted on Sunday or City Holidays in accordance with SMC 16.05.030, or between the hours of 8:00 p.m. and 7:00 a.m. Monday through Friday, and 6:00 p.m. and 9:00 a.m. Saturdays, except in the case of an emergency and then only upon notification and approval of the City.
- H. Notify local Fire District and City Public Works Department before opening any trench across any roadway and again when project is complete.
- I. All of the work shall be done under the supervision and to the satisfaction of the City's Public Works Director, City Engineer, or designee. The entire expense of said supervision to include the procurement of any "outside" consultants, as may be required by the City, shall be borne by the party or parties to whom this Permit is issued. Outside consultants may include, but are not limited to, engineers, materials testing laboratories, geotechnical, etc.
- J. The City hereby reserves the right to order the change of location or the removal of any structure or structures authorized by the Permit, at any time, said changes or removal to be made at the sole expense of the party or parties to whom this Permit is issued, or their successors and assigns.
- K. All such changes, reconstruction or relocation by the grantees shall be done in such manner as will cause the least interference with any of the City's work and the City shall in no way be held liable for any damage to the grantee by the reason of any such work by the City, its agents or representatives or by the exercise of any rights by the City upon the roads, streets, public places or structures in question.
- L. The Grantee recognizes and agrees that it is responsible for and will make at its own expense any changes that may be required and approved by the City in the location of work described herein.
- M. The Permit or privilege shall not be deemed or held to be an exclusive one and shall not prohibit the City from granting other permits or franchise rights of like or other nature to other public or private utilities, nor shall it prevent the City from using any of its roads, streets, or public places, or affect its right to full supervision and control over all or any part of them, none of which is hereby surrendered.
- N. The City may revoke, annul, change, amend, amplify, or terminate the Permit or any of the conditions herein enumerated if grantee fails to comply with any or all of its provisions, requirements or regulations as herein set forth or through willful or unreasonable neglect, fails to heed or comply with the notices given or if the full utility herein granted is not installed or operated and maintained in conformity herewith or et al or for any cause or reason whatsoever.
- O. The party or parties to whom the Permit is issued shall maintain at his or their sole expense the structure or object for which this permit is granted in condition satisfactory to the City's Public Works Director or City Engineer.

- P. In accepting this Permit, the grantee, his successors and assigns, agree that any damage or injury done to the property of the grantee or any expense incurred by him through the operation of a contractor, working for the City or of any City employee shall be at the sole expense of the grantee, his successors or assigns.
- Q. Clean-up of excavation and debris material shall be accomplished concurrently with the burying operation. At no time shall there be debris and/or excavated material extending along the area of construction for more than 500 feet without specific additional written approval of the City.

R. INITIAL _____ All temporary patches shall be maintained by the contractor until such time as the permanent pavement patch is in place. Final patch shall be completed within _____ **DOES NOT APPLY** _____ the trench. If the contractor is unable to maintain a patch for whatever reason, the City will patch it and charge the contractor the actual cost plus overhead.

I have read and understand all terms and conditions contained on all pages of this document, including Exhibit A Insurance. The undersigned hereby accepts this Permit subject to the terms and conditions as herein set forth.

Issued By: Stephen H. Noeske PE
Title: Development Review Manager
Date: July 12, 2023

Signed: _____
Printed Name: _____
Telephone No.: _____
Dated this _____ day of _____

EXHIBIT A**INSURANCE & INDEMNITY REQUIREMENTS
FOR RIGHT-OF-WAY PERMITS****Indemnification / Hold Harmless**

The Permittee shall defend, indemnify and hold the Public Entity, its officers, officials, employees and volunteers harmless from any and all claims, injuries, damages, losses or suits including attorney fees, arising out of or in connection with activities or operations performed by the Permittee or on the Permittee's behalf out of issuance of this Permit, except for injuries and damages caused by the sole negligence of the Public Entity.

However, should a court of competent jurisdiction determine that RCW 4.24.115 applies to this Permit, then the Permittee agrees to defend, indemnify and hold the Public Entity, its officers, officials, employees and volunteers harmless to the maximum extent permitted thereunder. It is further specifically and expressly understood that the indemnification provided herein constitutes the Permittee's waiver of immunity under Industrial Insurance, Title 51 RCW, solely for the purposes of this indemnification. This waiver has been mutually negotiated by the parties. The provisions of this section shall survive the expiration or termination of this Agreement.

A. Insurance Term

The Permittee shall procure and maintain for the duration of the Permit, insurance against claims for injuries to persons or damage to property which may arise from or in connection with operations or activities performed by or on the Permittee's behalf with the issuance of this Permit.

B. No Limitation

The Permittee's maintenance of insurance as required by the Permit shall not be construed to limit the liability of the Permittee to the coverage provided by such insurance, or otherwise limit the Public Entity's recourse to any remedy available at law or in equity.

C. Minimum Scope of Insurance

The Permittee shall obtain insurance of the types and coverage described below:

1. Commercial General Liability insurance shall be at least as broad as Insurance Services Office (ISO) occurrence form CG 00 01 and shall cover liability arising from operations, products-completed operations, and stop-gap liability. There shall be no exclusion for liability arising from explosion, collapse or underground property damage. The Public Entity shall be named as an additional insured under the Permittee's Commercial General Liability insurance policy using ISO Additional Insured-State or Political Subdivisions-Permits CG 20 12 or a substitute endorsement providing at least as broad coverage.
2. Automobile Liability insurance covering all owned, non-owned, hired and leased vehicles. Coverage shall be at least as broad as Insurance Services Office (ISO) form CA 00 01.

D. Minimum Amounts of Insurance

The Permittee shall maintain the following insurance limits:

1. Commercial General Liability insurance shall be written with limits no less than \$2,000,000 each occurrence, \$2,000,000 general aggregate and a \$2,000,000 products- completed operations aggregate limit.
2. Automobile Liability insurance with a minimum combined single limit for bodily injury and property damage of \$1,000,000 per accident.

E. Other Insurance Provision

The Permittee's Commercial General Liability insurance policy or policies are to contain or be endorsed to contain that they shall be primary insurance as respect the Public Entity. Any insurance, self-insurance, or self-insured pool coverage maintained by the Public Entity shall be excess of the Permittee's insurance and shall not contribute with it.

F. Acceptability of Insurers

Insurance is to be placed with insurers with a current A.M. Best rating of not less than A:VII.

G. Verification of Coverage

The Permittee shall furnish the Public Entity with original certificates and a copy of the amendatory endorsements, including the additional insured endorsement, evidencing the insurance requirements of the Permittee before issuance of the Permit.

H. Notice of Cancellation

The Permittee shall provide the Public Entity with written notice of any policy cancellation, within two business days of their receipt of such notice.

I. Failure to Maintain Insurance

Failure on the part of the Permittee to maintain the insurance as required shall constitute a material breach of the Permit, upon which the Public Entity may, after giving five business days' notice to the Permittee to correct the breach, immediately terminate the Permit or, at its discretion, procure or renew such insurance and pay any and all premiums in connection therewith, with any sums so expended to be repaid to the Public Entity on demand.

J. Public Entity Full Availability of Permittee Limits

If the Permittee maintains higher insurance limits than the minimums shown above, the Public Entity shall be insured for the full available limits of Commercial General and Excess or Umbrella liability maintained by the Permittee, irrespective of whether such limits maintained by the Permittee are greater than those required by this Permit or whether any certificate of insurance furnished to the Public Entity evidences limits of liability lower than those maintained by the Permittee.

City of Sammamish		DATE DUE	
Right of Way Use Permit Waiver			
To further assist us in scheduling your event, please complete the following permit and return it by the Due Date specified above.		Insurance Required: <input checked="" type="checkbox"/> Insurance Received: <input checked="" type="checkbox"/>	
Location/Roadway: <u>SE 24th Street</u>		Event Day:	Event Date:
Roads surrounding Beaver Lake (see Bike Map and Run Map)		SUNDAY	AUGUST 27, 2023
Estimated Attendance: <u>100</u>		Start:	End:
		0730	1130

Name of Group: Sammamish Running Type of Activity: 1/4 mile Swim, 13.7 mile Bike, 4.3 mile run

Contact Name: Michael Brisbois Day Phone: 708-668-5488 Evening Phone: 708-668-5488

Fax: _____ Email: mic@beaverlaketriathlon.com

Address: 27206 SE 10th Street City: Sammamish State: WA Zip: 98075

Alternate Contact: _____ Alternate Phone: _____

To assist us in serving you better, please mark each of the following items yes or no—they may require written authorization, additional fees, and/or insurance. If you have marked yes to any item give a specific explanation below.

Event Plans—Please Be Specific	YES	NO	COMMENTS
Advertise to public	<input checked="" type="checkbox"/>	<input type="checkbox"/>	_____
Athletic Activities	<input checked="" type="checkbox"/>	<input type="checkbox"/>	_____
Amplification	<input type="checkbox"/>	<input checked="" type="checkbox"/>	_____
Religious Service/group rally	<input type="checkbox"/>	<input checked="" type="checkbox"/>	_____
Sales (food, T-shirts, other, etc., please list)	<input type="checkbox"/>	<input checked="" type="checkbox"/>	_____
Event Participation Fees	<input checked="" type="checkbox"/>	<input type="checkbox"/>	_____
*participants required to pay admission	<input checked="" type="checkbox"/>	<input type="checkbox"/>	_____
*optional participant donation	<input type="checkbox"/>	<input checked="" type="checkbox"/>	_____

Explanation _____

Copy for Maintenance _____

See page 2 for more information—signature required

Please check the following items to acknowledge that you have read the information provided. Based upon the information supplied, proof of insurance may be required for approval of your event.

- yes I am aware that alcoholic beverages are not allowed in the right-of-way area that I have requested.
- yes I am aware that dunk tanks, hot air balloons and remote control airplanes or vehicles are not allowed in the area that I have requested.
- yes I realize that I am responsible for my own set-up and clean-up. My reserved time includes sufficient time for both these activities.
- yes If the event plans change, I am responsible to contact the City a minimum of 15 working days prior to the reservation date that I have requested.
- yes I am aware that any activities requiring set-up of special equipment must be approved in advance.

The organization using City of Sammamish right-of-way agrees to protect, defend, indemnify and save harmless the City, their officers, employees and agents from any and all costs, claims, judgments and awards for damages arising out of or in any way resulting from the use of City right-of-way. In the event the City incurs any fees, expenses and/or costs, including attorney fees, to enforce the provisions of this article, all such fees, expenses and costs shall be recoverable from the organization.

I, the undersigned hereby certify that I am the authorized and responsible representative of the petitioning organization, that the above statements are true to the best of my knowledge, and I have read all the regulations, policies and facility use requirements governing users of City facilities, which are enclosed with this permit. The undersigned agrees to accept any and all legal liability for damages to any or all parts of the right-of-way and/or traffic control devices or equipment covered in the permit and/or injuries incurred by any or all of the group members.

Signature: Michael Brisbois Date: 6/22/2023

Failure to sign and return this permit by the Date Due will cancel the proposed reservation request. No refunds will be given if cancellation is received less than 15 working days in advance of the event. When approved, this permit will be your receipt. We strongly recommend you bring the approved form with you to your event for proof of reservation.

FOR OFFICE USE ONLY

DATE DUE: _____

Approved by Stephen H. Noeske PE
City of Sammamish Staff
Development Review Manager

Date: 7/12/2023

Please return this permit application to:

**City of Sammamish
Public Works Department
801 228th Avenue SE
Sammamish, WA 98075
(425) 295-0500 * (425) 295-0600 fax**



NOTE:
THIS MAP HAS ONLY BEEN REVIEWED FOR COMPLIANCE WITHIN SAMMAMISH CITY LIMITS. APPLICANT IS RESPONSIBLE FOR MEETING ANY AND ALL PERMIT REQUIREMENTS FROM ANY JURISDICTION THROUGH WHICH THIS EVENT PASSES

<p>REVIEWED FOR COMPLIANCE</p> <p>WITH</p> <p>SMC 13.20, 14.01 AND 16.15</p> <p>AND</p> <p>CURRENT SAMMAMISH PUBLIC WORKS STANDARDS</p> <p>(SUBJECT TO FIELD INSPECTION AND CORRECTION)</p> <p>THIS DOCUMENT HAS BEEN REVIEWED</p> <p>FOR COMPLIANCE WITH SAMMAMISH MUNICIPAL CODE AND THE CURRENT VERSION</p> <p>OF SAMMAMISH PUBLIC WORKS STANDARDS AND ARE DEEMED:</p> <p>CONFORMS AS NOTED</p> <p>THE APPLICANT IS RESPONSIBLE FOR ALL ERRORS AND/OR OMISSIONS. THE CITY OF SAMMAMISH ASSUMES NO LIABILITY FOR ERRORS AND/OR OMISSIONS.</p> <p>STEPHEN H NOESKE PE</p> <p>CITY OF SAMMAMISH PUBLIC WORKS</p> <p>12 JULY 2023</p>

Beaver Lake Triathlon – Sunday August 27, 2023 8am

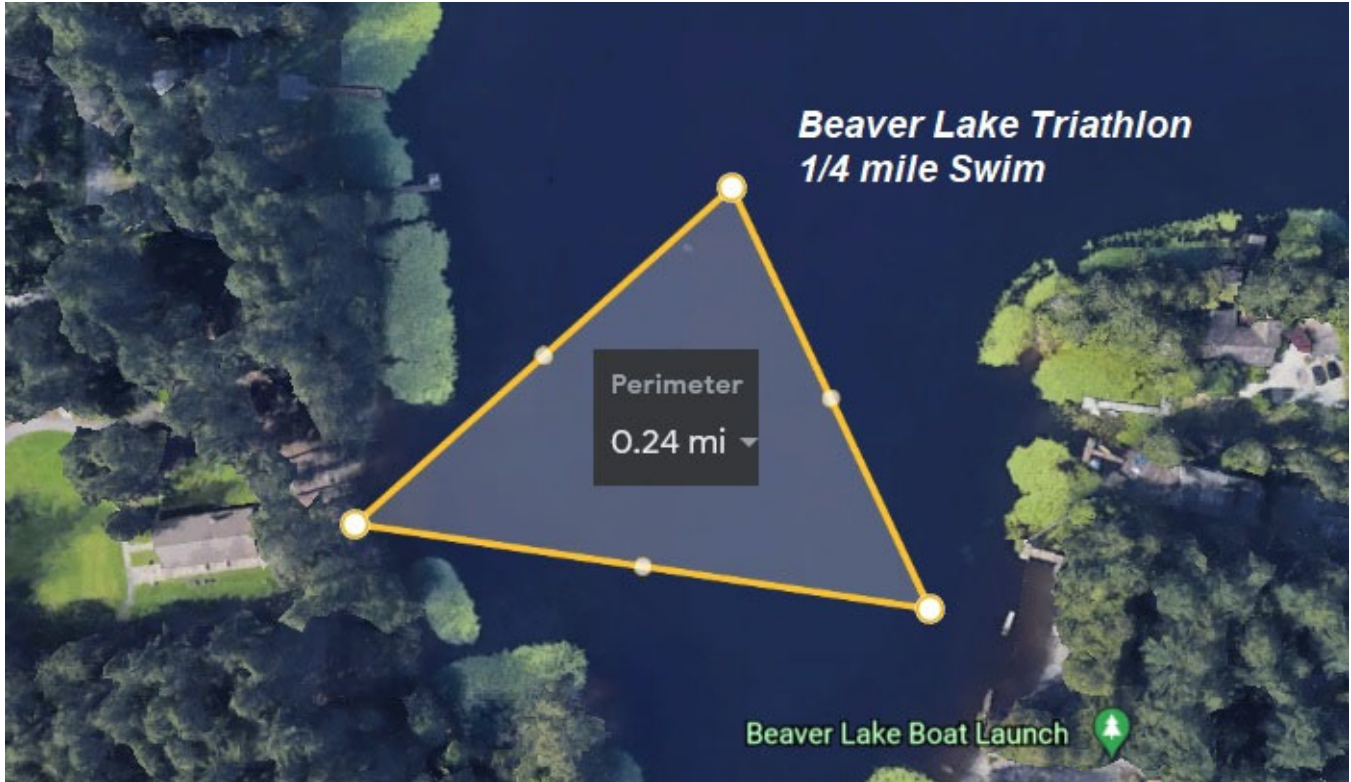

Proposed Swim Route – two lifeguards

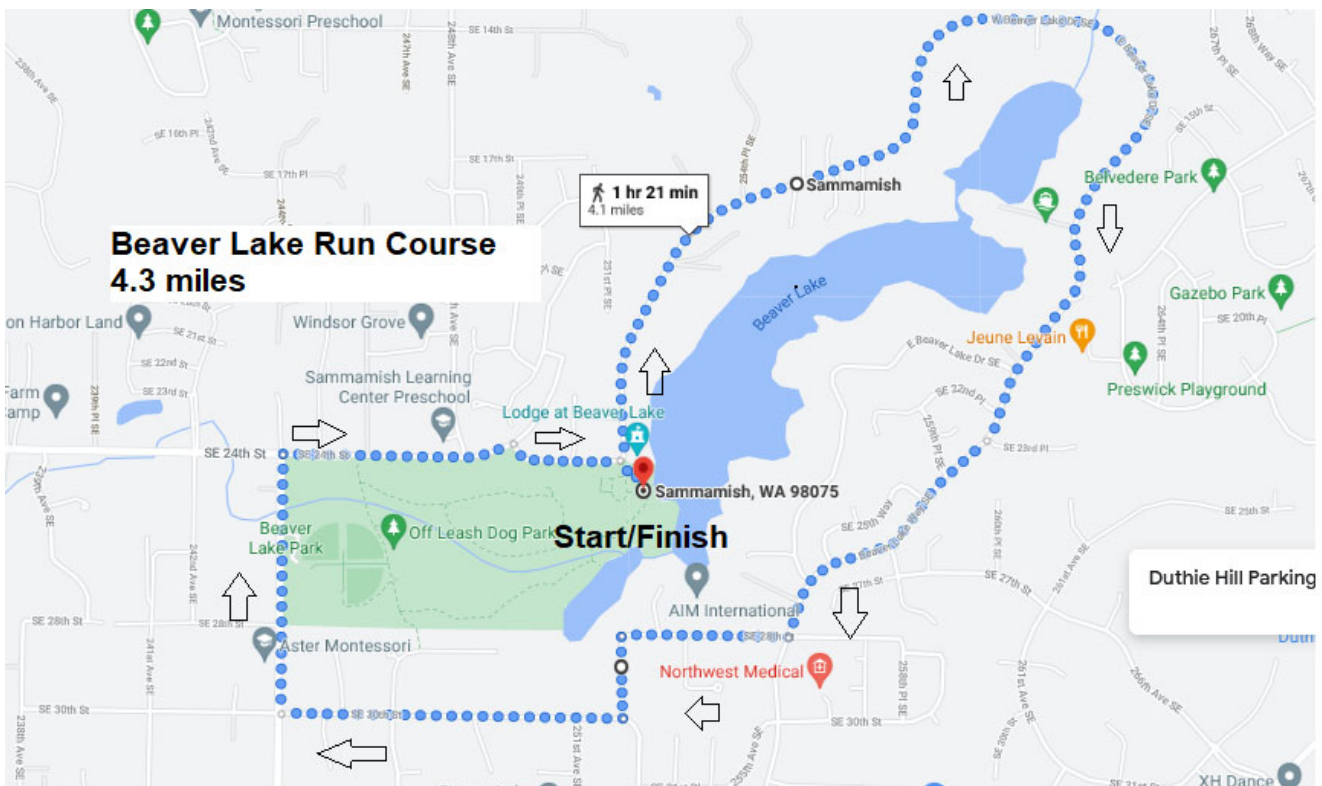

Proposed Run Course

Beaver Lake Triathlon – Sunday August 27, 2023 8am



Proposed transition area

REVIEWED FOR COMPLIANCE

WITH
SMC 13.20, 14.01 AND 16.15
AND

CURRENT SAMMAMISH PUBLIC WORKS STANDARDS
(SUBJECT TO FIELD INSPECTION AND CORRECTION)

THIS DOCUMENT HAS BEEN REVIEWED
FOR COMPLIANCE WITH SAMMAMISH MUNICIPAL CODE AND THE CURRENT VERSION
OF SAMMAMISH PUBLIC WORKS STANDARDS AND ARE DEEMED:

CONFORMS AS NOTED

THE APPLICANT IS RESPONSIBLE FOR ALL ERRORS AND/OR OMISSIONS. THE CITY OF SAMMAMISH ASSUMES
NO LIABILITY FOR ERRORS AND/OR OMISSIONS.

STEPHEN H NOESKE PE
CITY OF SAMMAMISH PUBLIC WORKS

12 JULY 2023

LOCATIONS:

East Beaver Lake Drive SE, SE 30th Street, and 255th Avenue SE

E Beaver Lake Drive SE, SE 32nd Street, 256th Avenue SE, SE Issaquah-Beaver Lake Road

ROW2023 - 03186

BEAVER LAKE TRIATHLON

TCP 14

Typical Intersection Lane Closure – Three-Lane Roadway

Chapter 2

Stationary Work Zones

BUFFER DATA														
LONGITUDINAL BUFFER SPACE = B														
SPEED (MPH)	25	30	35	40	45	50	55	60	65	70				
LENGTH (feet)	155	200	250	305	380	425	485	570	645	730				
TMA ROLL AHEAD DISTANCE = R														
HOST VEHICLE WEIGHT 5,000 TO 22,000 lbs.					HOST VEHICLE WEIGHT > 22,000 lbs.									
< 45 MPH			45-55 MPH		> 55 MPH			< 45 MPH			45-55 MPH		> 55 MPH	
100'			125'		172'			74'			100'		160'	
PROTECTIVE VEHICLE (WORK VEHICLE) = R														
NO SPECIFIED DISTANCE REQUIRED														

MINIMUM TAPER LENGTH = L (feet)										
Lane Width (feet)	25	30	35	40	45	50	55	60	65	70
10	105	150	205	270	450	500	550	-	-	-
11	115	165	225	295	495	550	605	660	-	-
12	125	180	245	320	540	600	660	720	780	-

SIGN SPACING = X (FEET) (1)		
RURAL HIGHWAYS	60 / 65 MPH	800'±
RURAL ROADS	45 / 55 MPH	500'±
RURAL ROADS & URBAN ARTERIALS	35 / 40 MPH	350'±
RURAL ROADS, URBAN ARTERIALS RESIDENTIAL & BUSINESS DISTRICTS	25 / 30 MPH	200'± (2)
URBAN STREETS	25 MPH OR LESS	100'± (2)
ALL SIGNS ARE 48" x 48" BLACK ON ORANGE UNLESS OTHERWISE DESIGNATED.		

CHANNELIZING DEVICE SPACING (FEET)		
MPH	TAPER	TANGENT
50 / 60	40	80
35 / 45	30	60
25 / 30	20	40

MEASURED DISTANCE FROM CROSS WALK

MEASURED DISTANCE FROM CROSS WALK

DEVICE SPACING 1/2 DISTANCE FOR OPPOSING TRAFFIC DEVICES

DEVICE SPACING 1/2 DISTANCE FOR OPPOSING TRAFFIC DEVICES

NOT APPLICABLE TO THIS PERMIT

MEASURED DISTANCE FROM CROSS WALK

LEGEND

- FLAGGING STATION
- SIGN LOCATION
- CHANNELIZING DEVICES AS MAY BE REQUIRED
- ~~PROTECTION VEHICLE - RECOMMENDED~~
- SIGN LOCATION ~ 5' MOUNTING HEIGHT - RECOMMENDED

- All spacing may be adjusted to accommodate intersections, and driveways.
- This spacing may be reduced in urban areas to fit roadway conditions.

NOTES

- ~~Protective vehicle recommended — may be a work vehicle strategically located to shield work operation.~~
- Recommend extending channelizing device taper across shoulder. Channelization devices at flagger stations recommended.
- If existing signal is present, signal shall be set to "red flash mode" or turn off during flagging operations.
- Law enforcement officer may be used in lieu of flagger's to control intersection traffic.
- For speed limit of 30 mph or less use sign W1-3 in lieu of sign W1-4.
- Maintain a minimum of one access point for each business within work area limits.
- ~~Consider using PCMS for additional advance warning.~~

TYPICAL INTERSECTION LANE CLOSURE ~ THREE LANE ROADWAY

TCP 14

NOTES:

- FLAGGERS SHALL COMMUNICATE WITH ONE ANOTHER USING RADIOS WITH SECURE CHANNELS.
- TURN LANES SHALL BE PROTECTED FROM USE IF FLAGGER CANNOT DIRECT.
- NO FLAGGER SHALL CONTROL INTERSECTION. ONLY OFF DUTY UNIFORMED POLICE OFFICERS ARE PERMITTED WITHIN INTERSECTIONS.
- OFF DUTY UNIFORMED POLICE OFFICERS SHALL DIRECT TRAFFIC WITHIN A TRAFFIC SIGNAL CONTROLLED INTERSECTION.
- APPLICANT SHALL NOTIFY LOCAL POLICE AND FIRE OF TEMPORARY TRAFFIC CONTROL.
- TRAFFIC SIGNALS SET TO FLASHING RED SHALL BE COORDINATED WITH SAMMAMISH TRAFFIC SIGNAL TECHNICIAN BY CALLING 425.295.0532 24 HOURS IN ADVANCE.

REVIEWED FOR COMPLIANCE

WITH
SMC 13.20, 14.01 AND 16.15
AND
CURRENT SAMMAMISH PUBLIC WORKS STANDARDS
(SUBJECT TO FIELD INSPECTION AND CORRECTION)
THIS DOCUMENT HAS BEEN REVIEWED
FOR COMPLIANCE WITH SAMMAMISH MUNICIPAL CODE AND THE CURRENT VERSION
OF SAMMAMISH PUBLIC WORKS STANDARDS AND ARE DEEMED:
CONFORMS AS NOTED
THE APPLICANT IS RESPONSIBLE FOR ALL ERRORS AND/OR OMISSIONS. THE CITY OF SAMMAMISH ASSUMES
NO LIABILITY FOR ERRORS AND/OR OMISSIONS.
STEPHEN H NOESKE PE
CITY OF SAMMAMISH PUBLIC WORKS
12 JULY 2023

BEAVER LAKE TRIATHLON

TCP 19 Typical Roundabout Flagging Operation

CHANNELIZING DEVICE SPACING (FEET)		
MPH	TAPER	TANGENT
35 / 45	30	60
25 / 30	20	40

RECOMMEND REDUCED DEVICE SPACING WITHIN ROUNDABOUT

SIGN SPACING = X (FEET) (1)		
RURAL ROADS	45/55 MPH	350'±
RURAL ROADS & URBAN ARTERIALS	35/40 MPH	200'± (2)
RURAL ROADS, URBAN ARTERIALS RESIDENTIAL & BUSINESS DISTRICTS	25/30 MPH	100'± (2)
URBAN STREETS	25 MPH OR LESS	

- (1) All spacing may be adjusted to accommodate intersections and driveways.
- (2) This spacing may be reduced in urban areas to fit roadway conditions.

NOTES

1. Night work requires additional roadway lighting at flagging stations.
2. Protective vehicle recommended - may be a work vehicle strategically located to shield work area.
3. This plan should be modified to meet the specific conditions of the location and the work operation.
4. If the work and all work vehicles are off of the travel lanes and island apron, a single Road Work Ahead sign per approach is all that is required.
5. Additional signing in center island may be necessary to assist traffic movement through roundabout.

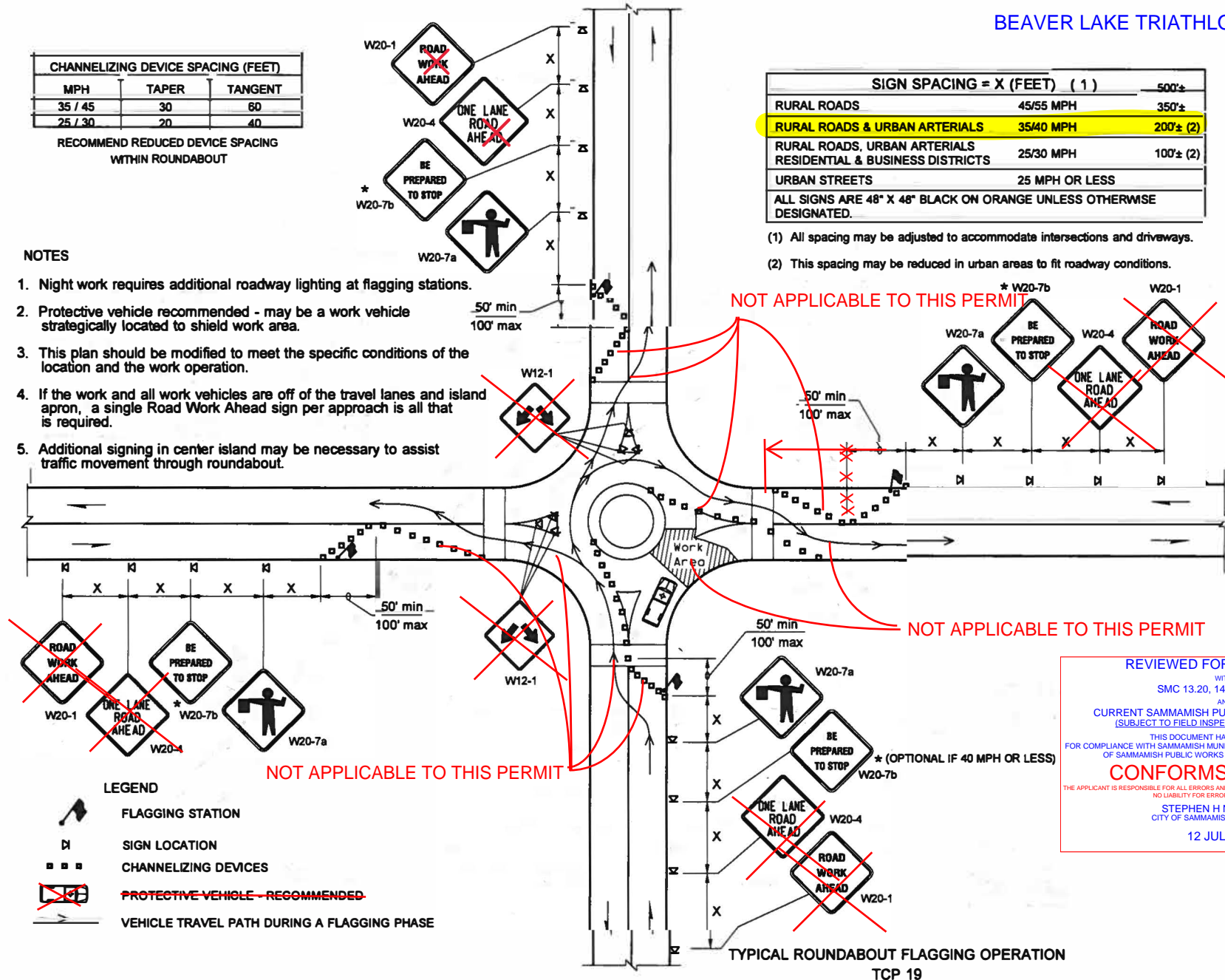

REVIEWED FOR COMPLIANCE
WITH
SMC 13.20, 14.01 AND 16.15
AND
CURRENT SAMMAMISH PUBLIC WORKS STANDARDS
(SUBJECT TO FIELD INSPECTION AND CORRECTION)
THIS DOCUMENT HAS BEEN REVIEWED
FOR COMPLIANCE WITH SAMMAMISH MUNICIPAL CODE AND THE CURRENT VERSION
OF SAMMAMISH PUBLIC WORKS STANDARDS AND ARE DEEMED:
CONFORMS AS NOTED
THE APPLICANT IS RESPONSIBLE FOR ALL ERRORS AND/OR OMISSIONS. THE CITY OF SAMMAMISH ASSUMES
NO LIABILITY FOR ERRORS AND/OR OMISSIONS.
STEPHEN H NOESKE PE
CITY OF SAMMAMISH PUBLIC WORKS
12 JULY 2023



ROW2023 - 03186

CERTIFICATE OF LIABILITY INSURANCE

DATE (MM/DD/YYYY)

6/22/2023

THIS CERTIFICATE IS ISSUED AS A MATTER OF INFORMATION ONLY AND CONFERS NO RIGHTS UPON THE CERTIFICATE HOLDER. THIS CERTIFICATE DOES NOT AFFIRMATIVELY OR NEGATIVELY AMEND, EXTEND OR ALTER THE COVERAGE AFFORDED BY THE POLICIES BELOW. THIS CERTIFICATE OF INSURANCE DOES NOT CONSTITUTE A CONTRACT BETWEEN THE ISSUING INSURER(S), AUTHORIZED REPRESENTATIVE OR PRODUCER, AND THE CERTIFICATE HOLDER.

IMPORTANT: If the certificate holder is an **ADDITIONAL INSURED**, the policy(ies) must have **ADDITIONAL INSURED** provisions or be endorsed. If **SUBROGATION IS WAIVED**, subject to the terms and conditions of the policy, certain policies may require an endorsement. A statement on this certificate does not confer rights to the certificate holder in lieu of such endorsement(s).

PRODUCER Insurance Office of America, Inc. 1855 West State Road 434 Longwood FL 32750	CONTACT NAME: PHONE (A/C, No. Ext): FAX (A/C, No): E-MAIL ADDRESS:
INSURED USA Triathlon of Colorado 5825 Delmonico Dr Colorado Springs CO 80919	INSURER(S) AFFORDING COVERAGE INSURER A: Everest National Insurance Company INSURER B: United States Fire Insurance Company INSURER C: INSURER D: INSURER E: INSURER F:
License#: 0E67768 USATRIA-01	NAIC # 10120 21113

COVERAGES

CERTIFICATE NUMBER: 1341416608

REVISION NUMBER:

THIS IS TO CERTIFY THAT THE POLICIES OF INSURANCE LISTED BELOW HAVE BEEN ISSUED TO THE INSURED NAMED ABOVE FOR THE POLICY PERIOD INDICATED. NOTWITHSTANDING ANY REQUIREMENT, TERM OR CONDITION OF ANY CONTRACT OR OTHER DOCUMENT WITH RESPECT TO WHICH THIS CERTIFICATE MAY BE ISSUED OR MAY PERTAIN, THE INSURANCE AFFORDED BY THE POLICIES DESCRIBED HEREIN IS SUBJECT TO ALL THE TERMS, EXCLUSIONS AND CONDITIONS OF SUCH POLICIES. LIMITS SHOWN MAY HAVE BEEN REDUCED BY PAID CLAIMS.

INSR LTR	TYPE OF INSURANCE	ADDL INSD	SUBR WVD	POLICY NUMBER	POLICY EFF (MM/DD/YYYY)	POLICY EXP (MM/DD/YYYY)	LIMITS
A	<input checked="" type="checkbox"/> COMMERCIAL GENERAL LIABILITY <input type="checkbox"/> CLAIMS-MADE <input checked="" type="checkbox"/> OCCUR <input checked="" type="checkbox"/> Participant LL GEN'L AGGREGATE LIMIT APPLIES PER: <input type="checkbox"/> POLICY <input type="checkbox"/> PRO-JECT <input type="checkbox"/> LOC <input checked="" type="checkbox"/> OTHER: Event	Y	Y	SI8ML02108-231	1/1/2023	1/1/2024	EACH OCCURRENCE \$ 1,000,000 DAMAGE TO RENTED PREMISES (Ea occurrence) \$ 1,000,000 MED EXP (Any one person) \$ Excluded PERSONAL & ADV INJURY \$ 1,000,000 GENERAL AGGREGATE \$ 2,000,000 PRODUCTS - COMP/OP AGG \$ 2,000,000 \$
	AUTOMOBILE LIABILITY <input type="checkbox"/> ANY AUTO <input type="checkbox"/> OWNED AUTOS ONLY <input type="checkbox"/> SCHEDULED AUTOS <input type="checkbox"/> HIRED AUTOS ONLY <input type="checkbox"/> NON-OWNED AUTOS ONLY 4077887933						COMBINED SINGLE LIMIT (Ea accident) \$ BODILY INJURY (Per person) \$ BODILY INJURY (Per accident) \$ PROPERTY DAMAGE (Per accident) \$ \$
A	<input type="checkbox"/> UMBRELLA LIAB <input checked="" type="checkbox"/> OCCUR <input checked="" type="checkbox"/> EXCESS LIAB <input type="checkbox"/> CLAIMS-MADE DED RETENTION \$	Y	Y	SI8EX01472-231	1/1/2023	1/1/2024	EACH OCCURRENCE \$ 10,000,000 AGGREGATE \$ 10,000,000 \$
	WORKERS COMPENSATION AND EMPLOYERS' LIABILITY ANY PROPRIETOR/PARTNER/EXECUTIVE OFFICER/MEMBER EXCLUDED? <input type="checkbox"/> Y/N (Mandatory in NH) If yes, describe under DESCRIPTION OF OPERATIONS below		N/A				PER STATUTE OTH-ER E.L. EACH ACCIDENT \$ E.L. DISEASE - EA EMPLOYEE \$ E.L. DISEASE - POLICY LIMIT \$
B	Participant Accident			US1929842	1/1/2023	1/1/2024	Accident Medical 25,000

DESCRIPTION OF OPERATIONS / LOCATIONS / VEHICLES (ACORD 101, Additional Remarks Schedule, may be attached if more space is required)

Coverage applies to the USA Triathlon sanctioned or approved event specified on this certificate.

The certificate holder is an additional insured, where required by written contract or agreement, but only with respect to the operations of the named insured, and subject to the provisions and limitations of form ECG20 600 - Additional Insured - Blanket when required by written contract, but only with respect to the USAT sanctioned or approved event specified on this certificate.

The General Liability policy is primary as per Form ECG24 520 (04/02) and the General Liability policy contains Form ECG24 522 (04/02): Waiver of Transfer of Rights of Recovery Against others to US, but only as required by written contract or agreement executed by the named insured prior to an occurrence resulting See Attached...

CERTIFICATE HOLDER

CANCELLATION

City of Sammamish
801 228th Avenue SE
Sammamish WA 98075

SHOULD ANY OF THE ABOVE DESCRIBED POLICIES BE CANCELLED BEFORE THE EXPIRATION DATE THEREOF, NOTICE WILL BE DELIVERED IN ACCORDANCE WITH THE POLICY PROVISIONS.

AUTHORIZED REPRESENTATIVE

© 1988-2015 ACORD CORPORATION. All rights reserved.



ADDITIONAL REMARKS SCHEDULE

Page 1 of 1

AGENCY Insurance Office of America, Inc.		NAMED INSURED USA Triathlon of Colorado 5825 Delmonico Dr Colorado Springs CO 80919	
POLICY NUMBER		EFFECTIVE DATE:	
CARRIER	NAIC CODE		

ADDITIONAL REMARKS

THIS ADDITIONAL REMARKS FORM IS A SCHEDULE TO ACORD FORM,
FORM NUMBER: 25 FORM TITLE: CERTIFICATE OF LIABILITY INSURANCE

in a loss or a claim.

Beaver Lake Triathlon 2023 | 2023-08-27 | 2023-08-27 | Sammamish, WA 98075

REVIEWED FOR COMPLIANCE

WITH
SMC 13.20, 14.01 AND 16.15

AND
CURRENT SAMMAMISH PUBLIC WORKS STANDARDS
(SUBJECT TO FIELD INSPECTION AND CORRECTION)

THIS DOCUMENT HAS BEEN REVIEWED
FOR COMPLIANCE WITH SAMMAMISH MUNICIPAL CODE AND THE CURRENT VERSION
OF SAMMAMISH PUBLIC WORKS STANDARDS AND ARE DEEMED:

CONFORMS AS NOTED

THE APPLICANT IS RESPONSIBLE FOR ALL ERRORS AND/OR OMISSIONS. THE CITY OF SAMMAMISH ASSUMES
NO LIABILITY FOR ERRORS AND/OR OMISSIONS.

STEPHEN H NOESKE PE
CITY OF SAMMAMISH PUBLIC WORKS

12 JULY 2023

THIS ENDORSEMENT CHANGES THE COVERAGE PART. PLEASE READ IT CAREFULLY.

ADDITIONAL INSURED – AUTOMATIC STATUS WHEN REQUIRED IN A WRITTEN AGREEMENT WITH YOU

This endorsement modifies insurance provided under the following:

COMMERCIAL GENERAL LIABILITY COVERAGE PART

- A. Section II – Who Is An Insured** is amended to include as an additional insured any person or organization with whom you have a written agreement that such person or organization be added as an additional insured on your Coverage Part. Such person or organization is an additional insured only with respect to liability for "bodily injury", "property damage" or "personal and advertising injury" but only to the extent caused, in whole or in part, by:
1. Your acts or omissions; or
 2. The acts or omissions of those acting on your behalf;
- in the performance of your operations for an additional insured.
- B.** The insurance afforded to an additional insured shall only include the insurance required by the terms of the written agreement and shall not be broader than the coverage provided within the terms of the Coverage Part.
- C.** The Limits of Insurance afforded to an additional insured shall be the lesser of the following:
1. The Limits of Insurance required by the written agreement between the parties; or
 2. The Limits of Insurance provided by this Coverage Part.
- D.** With respect to the insurance afforded to an additional insured, this insurance does not apply to "bodily injury", "property damage" or "personal and advertising injury" arising out of any act or omission of an additional insured or any of its employees.

THIS ENDORSEMENT CHANGES THE POLICY. PLEASE READ IT CAREFULLY.

WAIVER OF TRANSFER OF RIGHTS OF RECOVERY AGAINST OTHERS TO US

This endorsement modifies insurance provided under the following:
COMMERCIAL GENERAL LIABILITY COVERAGE PART

SCHEDULE

Name of Person or Organization:

ANY PERSON OR ORGANIZATION FOR WHOM THE NAMED INSURED HAS
AGREED BY WRITTEN CONTRACT TO FURNISH THIS WAIVER.

(If no entry appears above, information required to complete this endorsement will be shown in the Declarations as applicable to this endorsement.)

The TRANSFER OF RIGHTS OF RECOVERY AGAINST OTHERS TO US Condition (Section **IV** – COMMERCIAL GENERAL LIABILITY CONDITIONS) is amended by the addition of the following:

We waive any right of recovery we may have against the person or organization shown in the Schedule above because of payments we make for injury or damage arising out of your operations or "your work" done under a written agreement that requires you to waive your rights of recovery. The written agreement must be made prior to the date of the "occurrence". This waiver applies only to the person or organization shown in the Schedule above.

THIS ENDORSEMENT CHANGES THE POLICY. PLEASE READ IT CAREFULLY.

AMENDMENT – OTHER INSURANCE (PRIMARY NONCONTRIBUTORY)

This endorsement modifies insurance provided under the following:

COMMERCIAL GENERAL LIABILITY COVERAGE PART

A. Paragraph a. Primary Insurance of 4. Other Insurance of **SECTION IV COMMERCIAL GENERAL LIABILITY CONDITIONS** is replaced by the following:

a. Primary Insurance

This insurance is primary except when **b.** below applies. If this insurance is primary, our obligations are not affected unless any of the other insurance is also primary. Then, we will share with all that other insurance by the method described in **c.** below, except that we will not seek contribution from any party with whom you have agreed in a written contract or agreement that this insurance will be primary and noncontributory, if the written contract or agreement was made prior to the subject "occurrence" or offense.